

TO LET



House - Terraced (EPC Rating: C)

27 SOTHERTON ROAD, NORWICH, NR4
7DA

£1680pcm

- Suitable for Student/professionals
- Fully Furnished
- 4 Double Bedrooms
- Separate bathroom and WC
- Enclosed Garden



4 Bedroom House - Terraced located in Norwich

Nestled on Sotherton Road in the vibrant city of Norwich, this charming terraced house offers an ideal living space for both students and professionals alike. With four generously sized double bedrooms, this property provides ample room for comfortable living and is perfect for those seeking a shared home environment.

One of the standout features of this home is the enclosed garden, providing a private outdoor space for relaxation or social gatherings. This area is perfect for enjoying the fresh air or hosting friends during the warmer months.

Located in a desirable area of Norwich, this property is well-connected to local amenities, transport links, and the vibrant culture of the city. Whether you are a student looking for a comfortable place to study or a professional seeking a convenient home, this terraced house on Sotherton Road is a fantastic opportunity not to be missed.

Living room

12'10" x 10'10"

Fully furnished with 1 2 seater sofa and single chair, coffee table and book case. Carpeted with UPVC white windows

Bedroom 1

9'8" x 10'10"

Fully furnished bedroom with double bed, desk and chair, wardrobe and chest of drawers. Carpeted with white UPVC window.

Kitchen

10'2" x 12'6"

Fully fitted kitchen with two fridge freezers, oven and hob, microwave and all necessities. White UPVC door leading to rear garden.

Bedroom 2

9'10" x 12'10"

Fully furnished bedroom with double bed, fitted wardrobe, chest of drawers and desk. Carpeted with White UPVC window.

Bedroom 3

8'10" x 10'10"

Fully furnished bedroom with double bed, chest of drawers and desk. Carpeted with UPVC white window.

bedroom 4

10'2" x 10'11"

Fully furnished room with double bed, built in large wardrobe, chest of drawers and desk and chair. Carpeted with white UPVC window.



NORWICH LETTINGS | 3 VISION PARK, QUEENS HILLS, NORWICH, NR8 5HD

GROUND FLOOR
363 sq.ft. (33.8 sq.m.) approx.

1ST FLOOR
379 sq.ft. (35.2 sq.m.) approx.

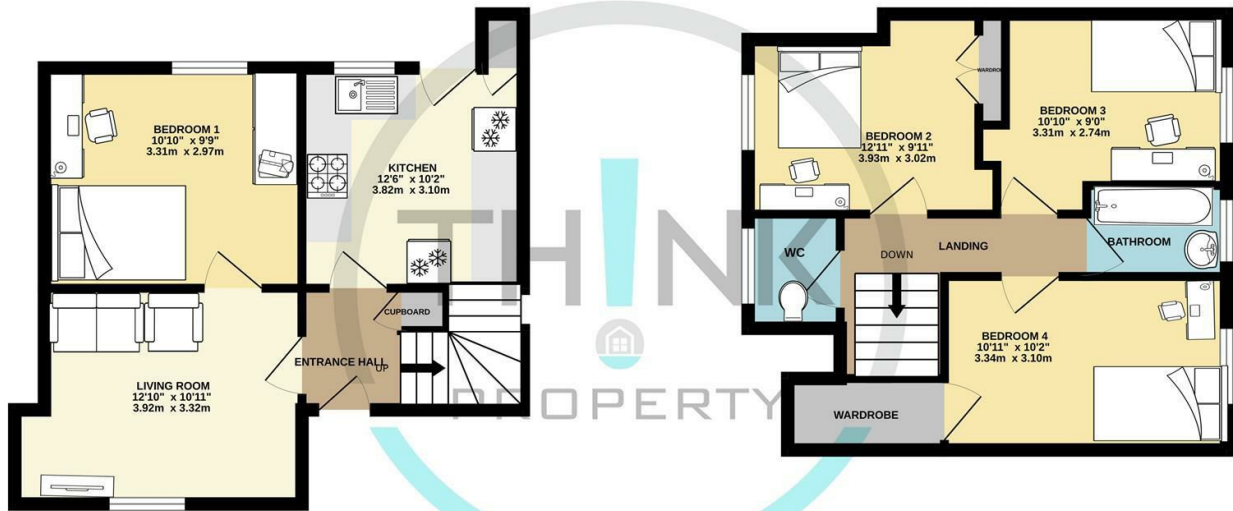

TOTAL FLOOR AREA : 742 sq.ft. (68.9 sq.m.) approx.

Whilst every attempt has been made to ensure the accuracy of the floorplan contained here, measurements of doors, windows, rooms and any other items are approximate and no responsibility is taken for any error, omission or mis-statement. This plan is for illustrative purposes only and should be used as such by any prospective purchaser. The services, systems and appliances shown have not been tested and no guarantee as to their operability or efficiency can be given.
Made with Metropix ©2026

Council Tax Band

B

Energy Performance Graph

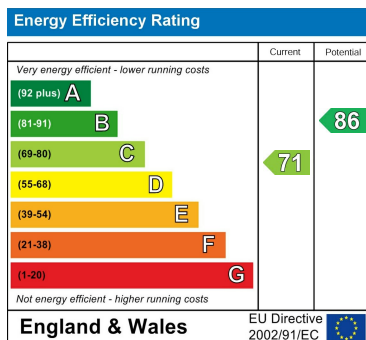

Call us on

01603 338433

norwich@thinkproperty.ltd

<https://www.thinkproperty.ltd/>

Agents Note: Whilst every care has been taken to prepare these particulars, they are for guidance purposes only. All measurements are approximate and are for general guidance purposes only and whilst every care has been taken to ensure their accuracy, they should not be relied upon and potential buyers are advised to recheck the measurements.

